

569 ESB/EGB

SET INPUT EXPANDER/GATE OUTPUT EXPANDER BASIC

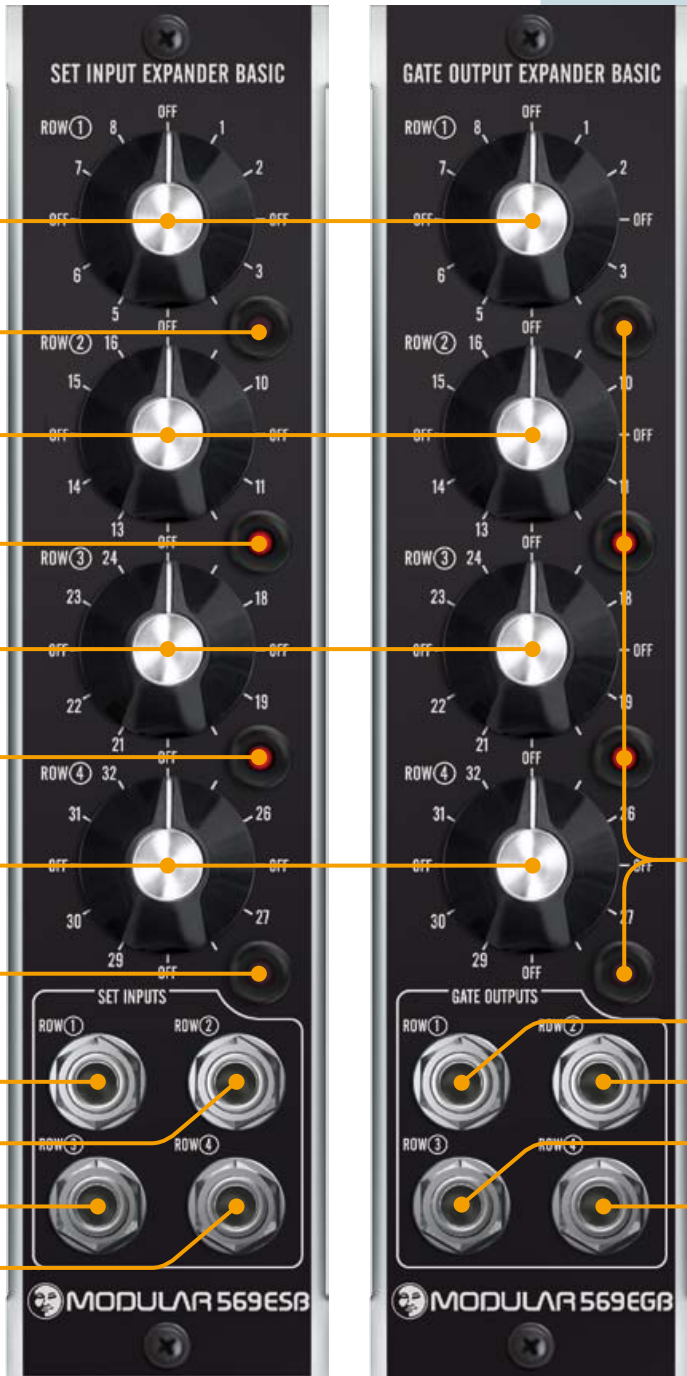

The **M 569 ESB** and **M 569 EGB BASIC EXPANDER** modules are companions to the M 569 sequencer module.

The **M 569 ESB** expands the M569 by four switchable set inputs, one position per row can be specified.

The four push-button switches on the 569 ESB provide a way to manually access a stage instantly without stepping through all stages. This should be handy for setting up sequences, changing/fixing a particular note and for playing the sequencer on the fly.

All four inputs are daisy-chained: 1 → 2 → 3 → 4 = one signal can set all rows (the 569 sequencer in 4-channel mode) at once

The **M 569 EGB** expands the M 569 by four switchable gate outputs, one position per row can be specified.

The four push-button switches on the 569 EGB are extra manual gate buttons for the four rows of the sequencer.

Manual gate buttons for sequencer row 1/2/3/4

Gate output jack for row one

Gate output jack for row two

Gate output jack for row three

Gate output jack for row four

Position switch for row 1 (stage 1–8) of the sequencer

Manual set button to access a stage in row one

Position switch for row 2 (stage 9–16) of the sequencer

Manual set button to access a stage in row two

Position switch for row 3 (stage 17–24) of the sequencer

Manual set button to access a stage in row three

Position switch for row 4 (stage 25–32) of the sequencer

Manual set button to access a stage in row four

Set input jack for row one

Set input jack for row two

Set input jack for row three

Set input jack for row four

569 ESB/EGB CP

SET INPUT EXPANDER/GATE OUTPUT EXPANDER BASIC

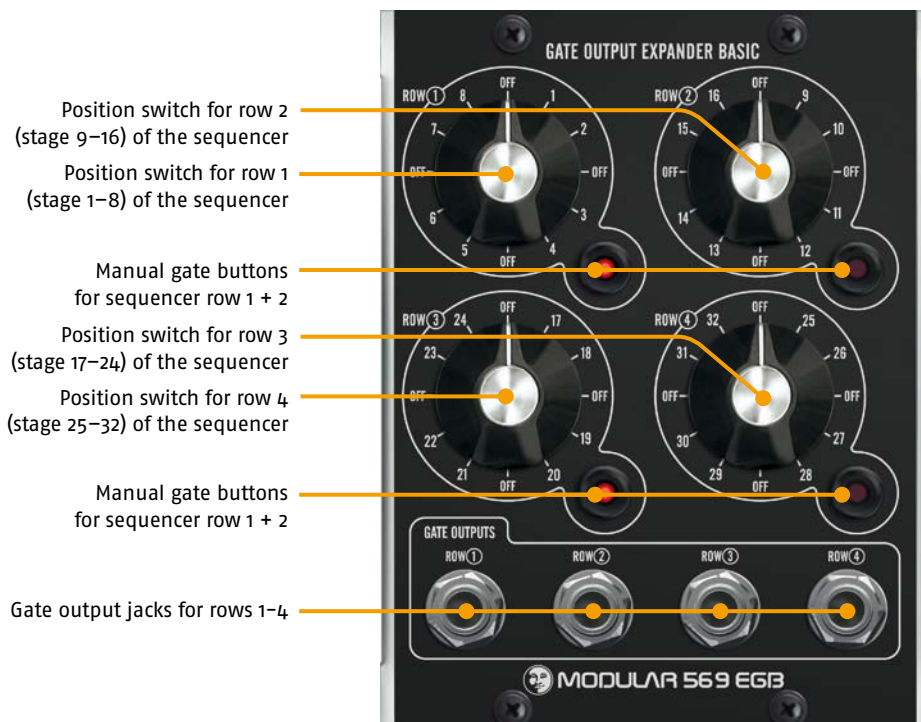
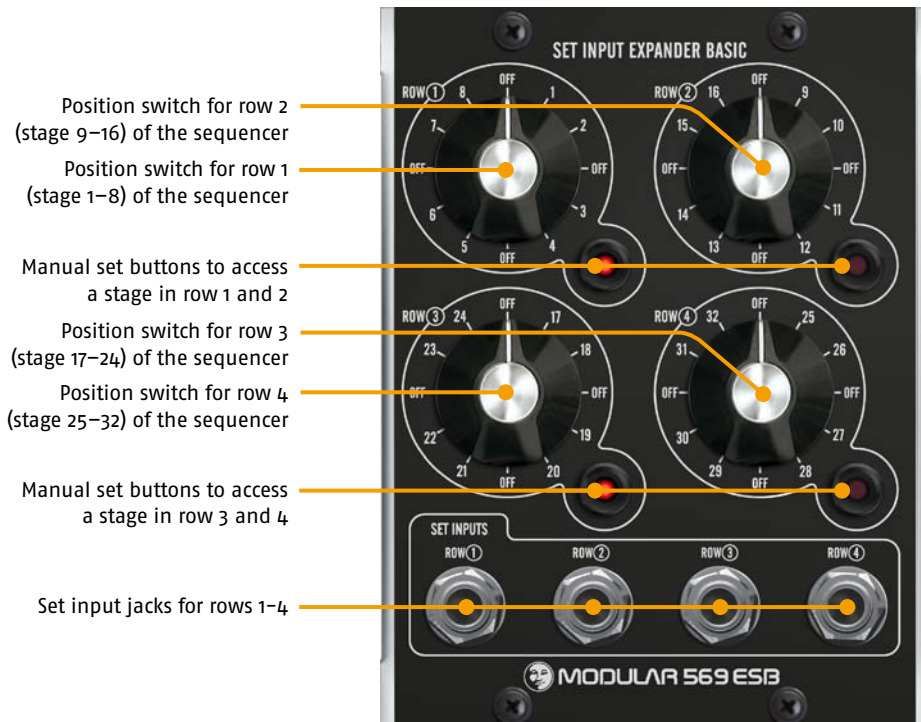

The **M 569 ESB CP** and **M 569 EGB CP BASIC EXPANDER** modules are companions to the M 569 sequencer module in 2U console canel format.

The **M 569 ESB CP** expands the M569 by four switchable set inputs, one position per row can be specified.

The four push-button switches on the 569 ESB CP provide a way to manually access a stage instantly without stepping through all stages. This should be handy for setting up sequences, changing/fixing a particular note and for playing the sequencer on the fly.

All four inputs are daisy-chained: 1 → 2 → 3 → 4 = one signal can set all rows (the 569 sequencer in 4-channel mode) at once.

The **M 569 EGB CP** expands the M 569 by four switchable gate outputs, one position per row can be specified.

The four push-button switches on the 569 EGB CP are extra manual gate buttons for the four rows of the sequencer.